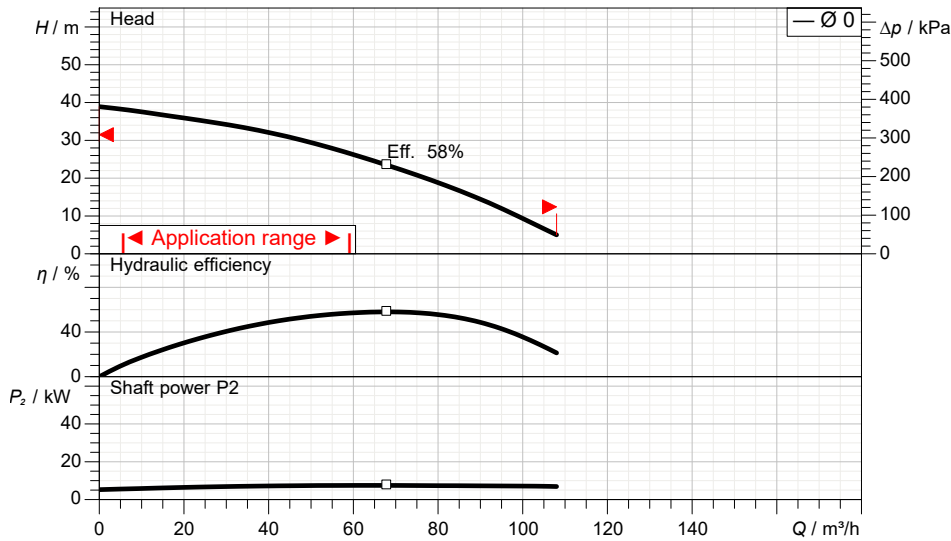

80SF27.5-53 380-415V
Technical specification
3~ 50 Hz

Characteristic curves according to UNI EN ISO 9906:2012
 P₂<10kW: paragraph 4.4.2, 10kW<P₂<100kW: Grade 3B, P₂>100kW: Grade 2E
 for pumps with standard material combination
 Pump performance is based on tests conducted with clean water at 20 °C.

Pump

Series	SF
Pump name	80SF27.5-53 380-415V
Standard	

Motor data

Motor	SM1-2-7.5SF 400DYT
Rated voltage	380 V
Frequency	50 Hz
Motor phases	3~
Number of poles	2
Rated power P ₂	7.5 kW
Rated current	15.3 A
rpm	2945 1/min
Rated torque	24.3 Nm
Start*	Direct starting

Degree of protection	IP 68
Insulation class	F
Protection device	Circle thermal protector
Type of oil	Turbine oil VG32
Oil amount	2.1 l

Hydraulic

Free passage	19 mm
Impeller type	Semi-open impeller
Max. hydraulic efficiency	58.0 %
Discharge	80 mm
Curve tolerance	UNI EN ISO 9906:2012

Operating limits (standard pumps)

Max. liquid temperature	40 °C
Max. density treated liquid	1030 kg/m ³
pH treated liquid	5-9
Max. start per hour (equally distributed)	10
Wet/dry use	WET
Operating mode	S1

Construction materials

Motor enclosure	Gray Iron Casting 200
Shaft	420J2 Stainless Steel
Pump Casing	Gray Iron Casting 200
Impeller	Gray Iron Casting 200
Suction Cover	Gray Iron Casting 200
Suction plate	N/A
Painting	Epoxy paint (Black)
Screws	304 Stainless Steel
Gaskets	NBR

Construction features

Power cable1	4C*5.5mm ²
Power cable2	N/A
Sheath	2PNCT
Control cable	N/A
Sheath	N/A
Cable length*	8 m
Mechanical seals	H-30A
Weight**	128 kg

* Please inquire about cable extensions
 ** cable's weight not included

Monitoring features

Monitoring option	
leaking sensor -	N/A
monitoring equipment -	N/A

80SF27.5-53 380-415V
Pump performance curves
3 ~ 50 Hz

Discharge	Head	Capacity	Rated power	Voltage	Current	rpm
80 mm			7.5 kW	380 V	15.3 A	2945 1/min

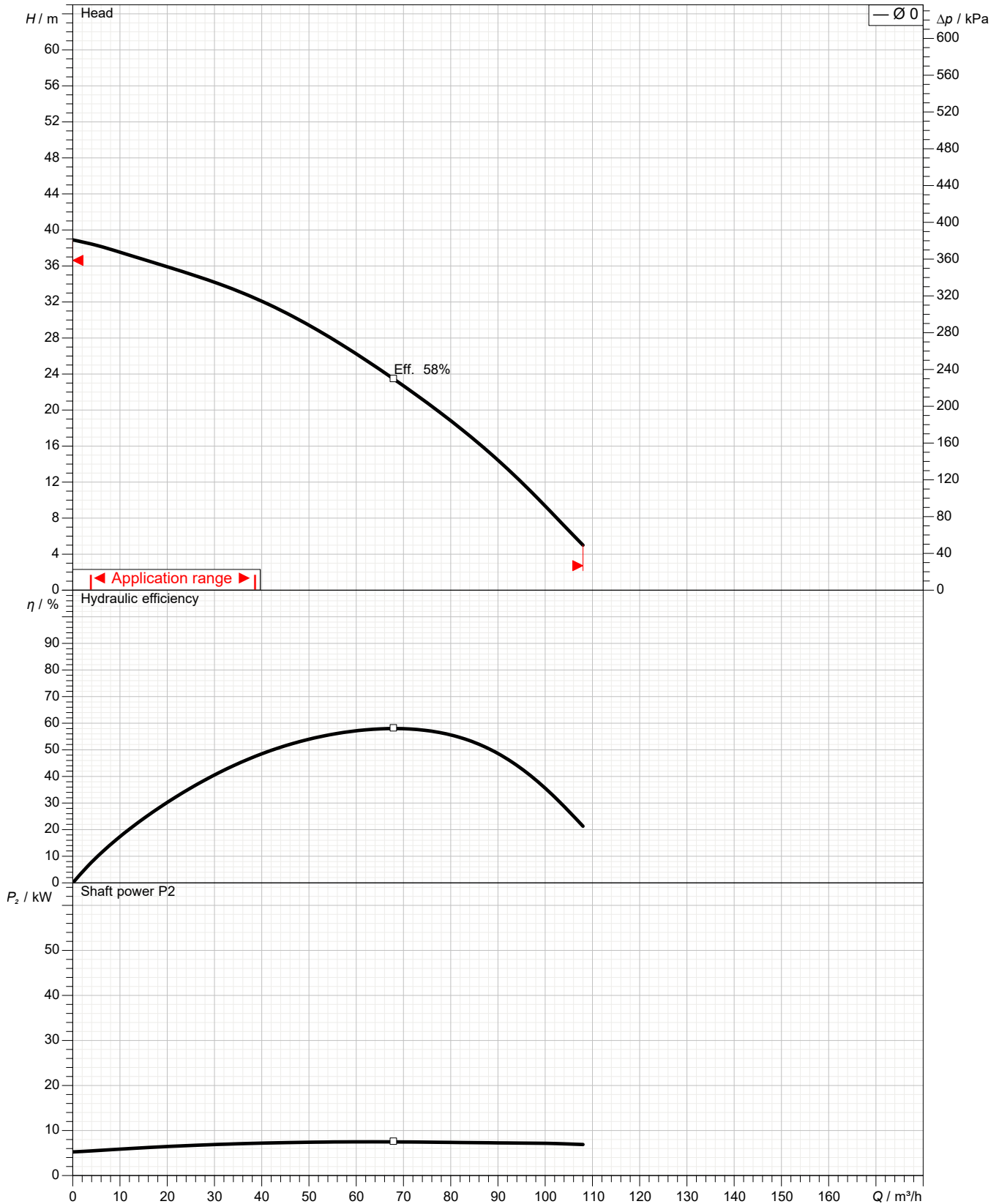

Characteristic curves according to UNI EN ISO 9906:2012 for pumps with standard material combination
 P₂<10kW: paragraph 4.4.2, 10kW<P₂<100kW: Grade 3B, P₂>100kW: Grade 2B
 Pump performance is based on tests conducted with clean water at 20 °C.

SECTIONAL DRAWING		No.	No.	A-21075-3
TYPE	Submersible High-Head Wastewater Pump	MODEL	80SF25.5 -53/63 80SF27.5 -53/63	

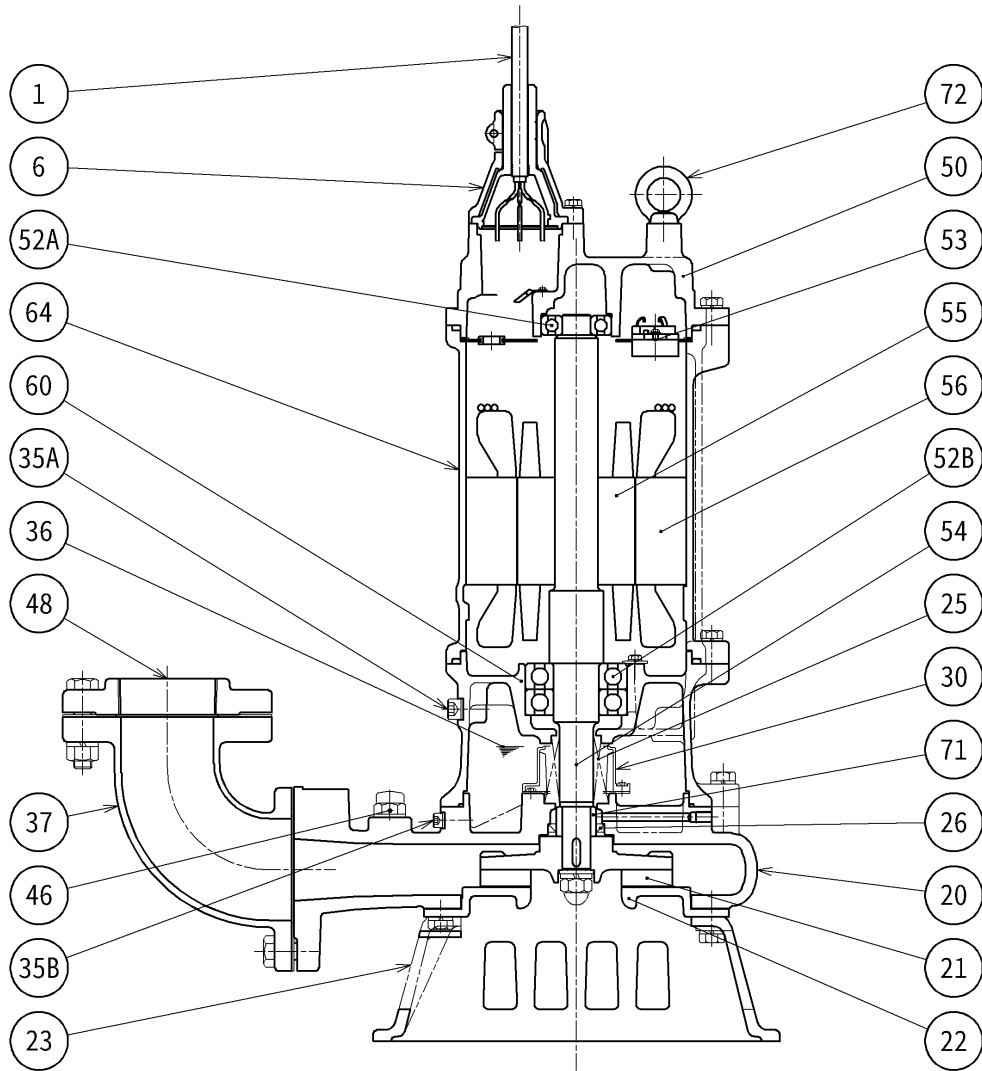

REQ. SPECIFICATION	

No.	DESCRIPTION	Q'TY	MATERIAL / NOTE	No.	DESCRIPTION	Q'TY	MATERIAL / NOTE
1	Cable	1	Chloroprene Sheath	48	Screwed Flange	1	Gray Iron Casting 200
6	Stuffing Box	1	Gray Iron Casting 200	50	Motor Bracket	1	Gray Iron Casting 200
20	Pump Casing	1	Gray Iron Casting 200	52A	Upper Bearing	1	6305ZZC3
21	Impeller	1	Gray Iron Casting 200	52B	Lower Bearing	1	6308ZZD2C3
22	Suction Cover	1	Gray Iron Casting 200	53	Motor Protector	1	
23	Strainer Stand	1	Ductile Iron Casting 450	54	Shaft	1	420J2 Stainless Steel
25	Mechanical Seal	1	H-30A	55	Rotor	1	
26	Oil Seal	1	TC35508	56	Stator	1	
30	Oil Lifter	1	Plastic	60	Bearing Housing	1	Gray Iron Casting 150
35A	Oil Plug	1	304 Stainless Steel	64	Motor Frame	1	Gray Iron Casting 200
35B	Oil Plug	1	304 Stainless Steel	71	Shaft Sleeve	1	403 Stainless Steel
36	Lubricant		Turbine Oil(ISO VG32)	72	Eyebolt	2	304 Stainless Steel
37	Discharge Bend	1	Gray Iron Casting 200				
46	Air Release Valve	1	Nylon				

TSURUMI MFG. CO., LTD.

Created on: 2026-05-05

All data shown are not binding. Tsurumi reserves the right to change data and dimensions without notice.